

FED. ROAD DIV. NO.	STATE	F A PROJECT NO.	FISCAL YEAR	SHEET NO.
3	FLA.			

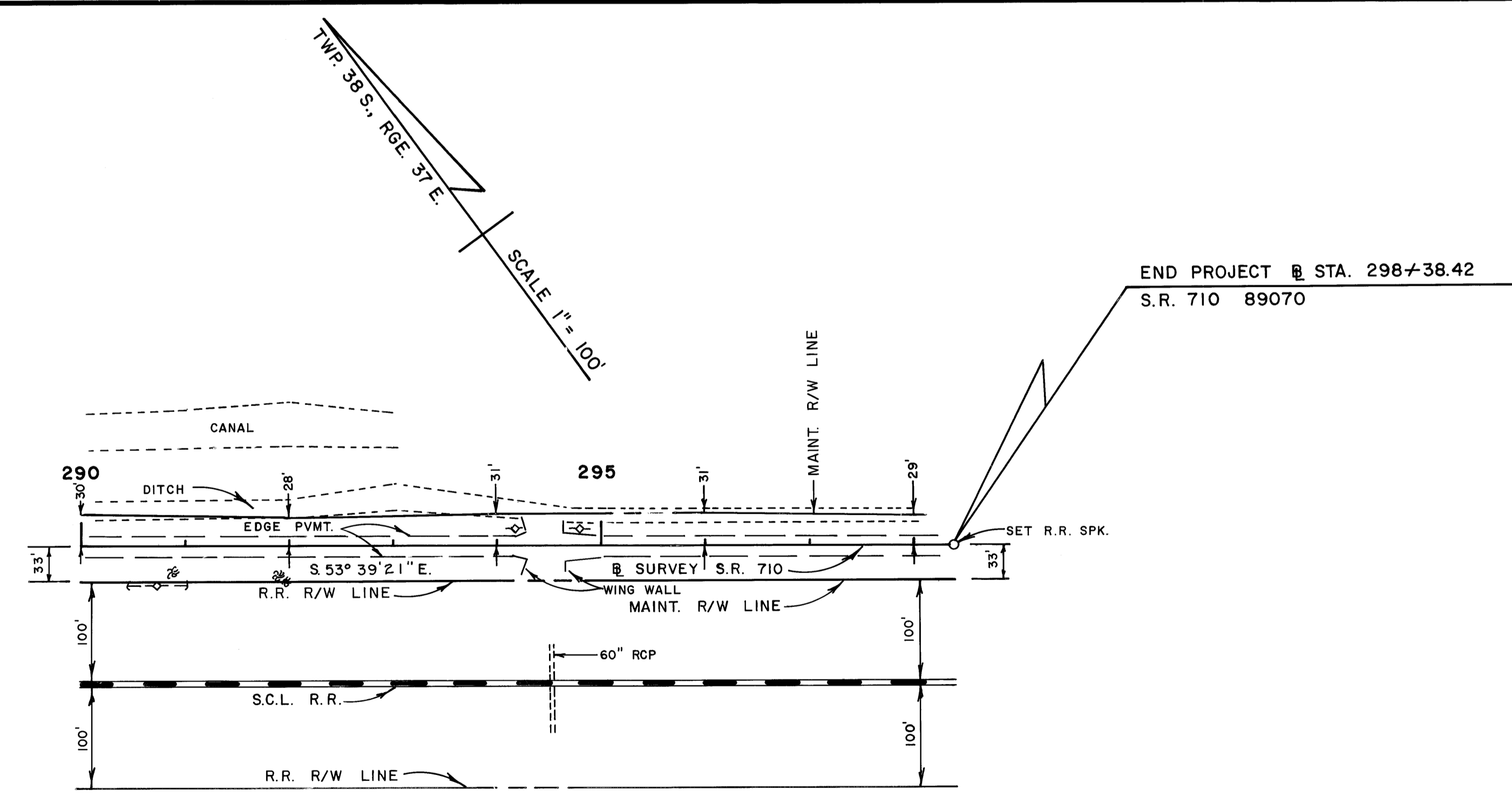
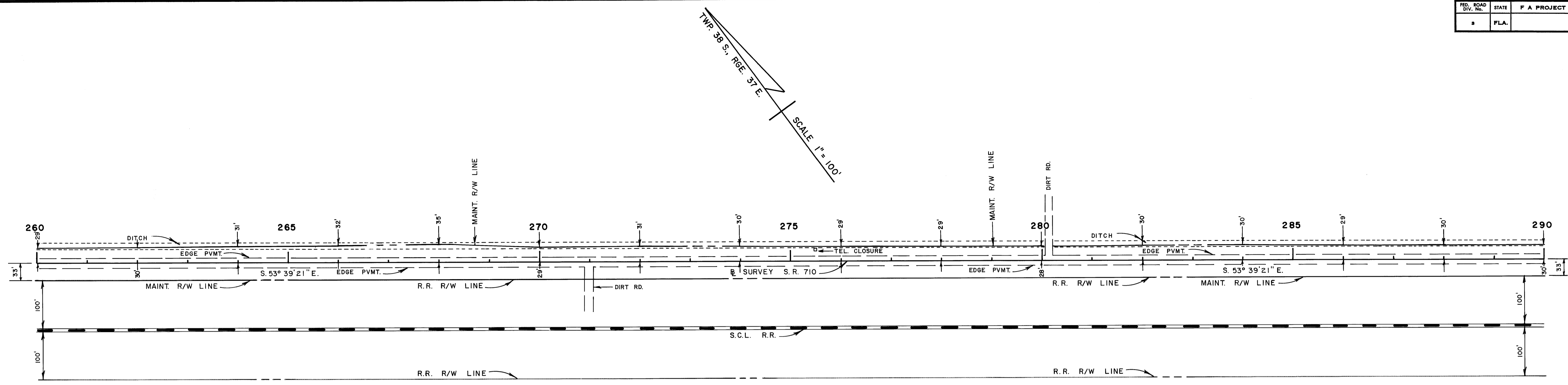

THIS IS TO CERTIFY THAT THE WITHIN AND ATTACHED SHEETS NUMBERED ONE (1) THRU FIVE (5) CONSTITUTES A TRUE COPY OF THE OFFICIAL RIGHT OF WAY MAP SHOWING LOCATION AND SURVEY BY THE DEPT. OF TRANSPORTATION OF FLORIDA FOR A PORTION OF STATE ROAD 710 DESIGNATED AS SECTION 89070 IN MARTIN COUNTY, FLORIDA.

THE PROPERTY OUTLINED IN RED INK ON THE SAID SHEETS HAS BEEN VESTED IN THE DEPT. OF TRANSPORTATION OF FLORIDA, PURSUANT TO THE PROVISIONS OF SECTION 341.59 FLORIDA STATUTES OF 1951 AND SECTION 337.31 FLORIDA STATUTES OF 1955, AND/OR UNDER FORMAL CONVEYANCE AND OTHER INSTRUMENTS.

IN WITNESS WHEREOF WE HAVE HEREUNTO SET OUR HANDS AND AFFIXED THE SEAL OF THE DEPT. OF TRANSPORTATION OF FLORIDA, AT TALLAHASSEE, FLORIDA THIS 27th DAY OF February AD 1975.

Tom Webb
 SECRETARY OF TRANSPORTATION
 STATE OF FLORIDA DEPARTMENT
 OF TRANSPORTATION

Cathy Lusk
 EXECUTIVE SECRETARY

THIS IS TO CERTIFY THAT THE RIGHT OF WAY LIMITS AS SHOWN ON THIS MAP HAVE BEEN MAINTAINED CONTINUOUSLY FOR FOUR (4) YEARS IMMEDIATELY PAST WITHOUT INTERRUPTION OR DISTURBANCE BETWEEN MILE POSTS 0.000 AND 5.100, (S.L.D.)

J.R. Shepton
 MAINTENANCE ENGINEER

ACCEPTED FOR FILES AND RECORDED IN THE PUBLIC RECORDS OF MARTIN COUNTY, FLORIDA, THIS _____ DAY OF _____ A.D. 19____ IN RIGHT OF WAY PLAT BOOK _____ PAGE _____.

CLERK OF CIRCUIT COURT OF MARTIN COUNTY FLORIDA

STATE OF FLORIDA DEPARTMENT OF TRANSPORTATION			
MAINTENANCE MAP			
STATE ROAD NO. 710		MARTIN COUNTY	
DRAWN	BY	DATE	APPROVED BY
STOUT	STOUT	12-22-75	<i>W.D. Simpson</i>
TRACED	HALL	JAN. 76	<i>D.S. Webb</i>
CHECKED			
INDEXED			
SECTION 89070-2508			SHEET 5 OF 5